

Columbia River

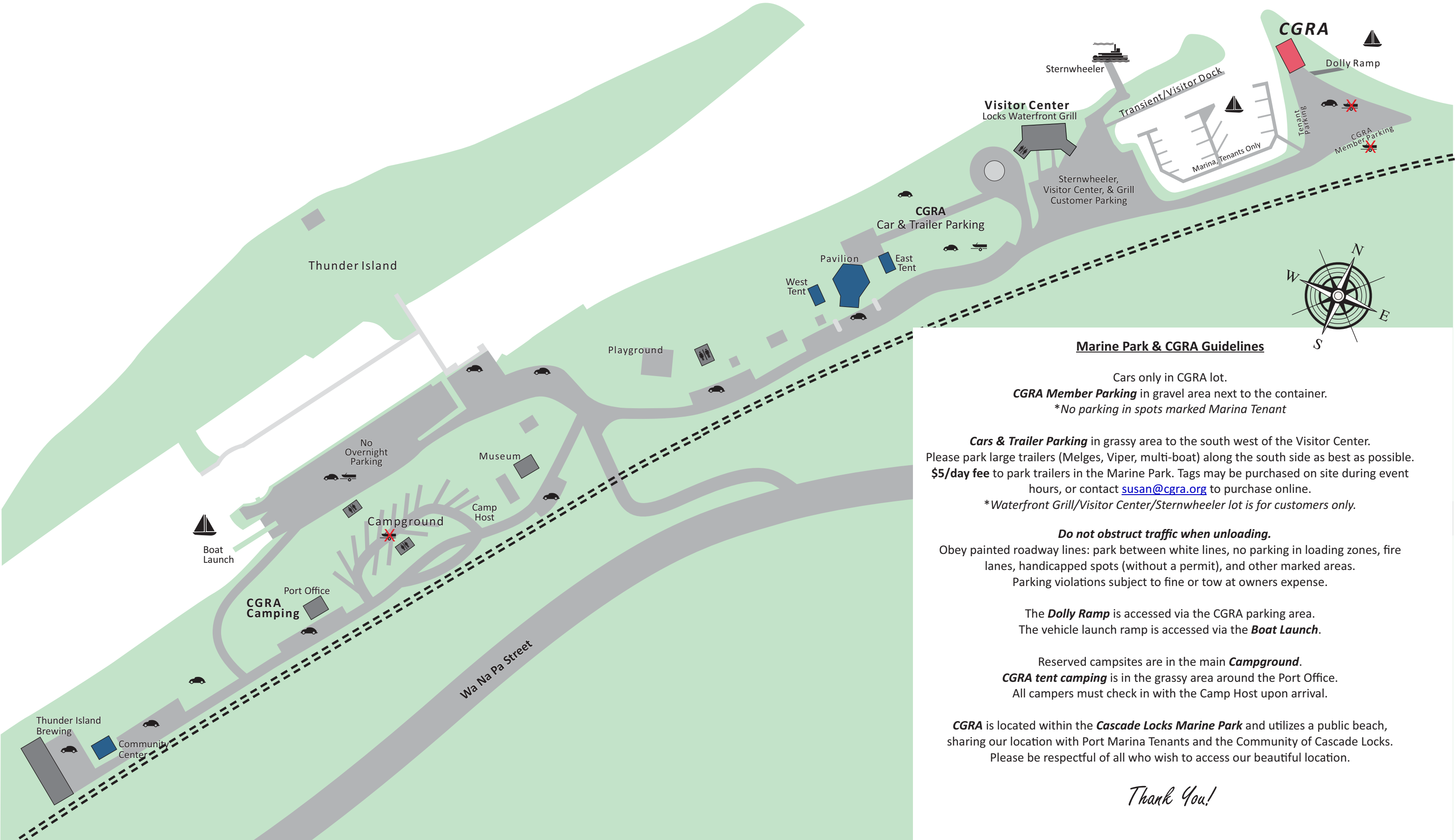

Marine Park & CGRA Guidelines

Cars only in CGRA lot.
CGRA Member Parking in gravel area next to the container.
**No parking in spots marked Marina Tenant*

Cars & Trailer Parking in grassy area to the south west of the Visitor Center.
 Please park large trailers (Melges, Viper, multi-boat) along the south side as best as possible.
\$5/day fee to park trailers in the Marine Park. Tags may be purchased on site during event hours, or contact susan@cgra.org to purchase online.
**Waterfront Grill/Visitor Center/Sternwheeler lot is for customers only.*

Do not obstruct traffic when unloading.
 Obey painted roadway lines: park between white lines, no parking in loading zones, fire lanes, handicapped spots (without a permit), and other marked areas.
 Parking violations subject to fine or tow at owners expense.

The **Dolly Ramp** is accessed via the CGRA parking area.
 The vehicle launch ramp is accessed via the **Boat Launch**.

Reserved campsites are in the main **Campground**.
CGRA tent camping is in the grassy area around the Port Office.
 All campers must check in with the Camp Host upon arrival.

CGRA is located within the **Cascade Locks Marine Park** and utilizes a public beach, sharing our location with Port Marina Tenants and the Community of Cascade Locks.
 Please be respectful of all who wish to access our beautiful location.

Thank You!